

INSTRUMENT RECORD CARD

test temperature	0 °C	100 °C
instrument indication		

serial no. _____

calibrated by _____ date _____

This Thermapen has been checked or calibrated against reference instrument(s) calibrated by a UKAS Accredited Calibration Laboratory.



Thermapen[®] 3 Thermometer



manufactured by
Electronic Temperature Instruments Ltd
Worthing · West Sussex · BN14 8HQ
tel: 01903 202151 · email: sales@etiltd.com
www.etiltd.com

Operating Instructions

INSTRUMENT OPERATION - The instrument is switched on by unfolding the probe until the display shows the temperature. The unit is turned off by folding the probe back into the rubber probe retainer. The probe should not be rotated more than 180 degrees as damage will occur. It is recommended to store the probe, in the closed position, when not in use.

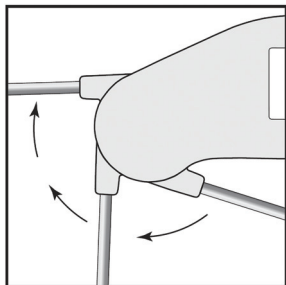

Apply the tip of the probe to the substance, surface or area to be measured. The probe should be allowed adequate time to stabilise to the temperature of the item to be measured.

INSTRUMENT CONFIGURATION

- This instrument has four user selectable slide switches (switch bank), adjustable with a paperclip, and a single push button 'Trim Adjust' which is located under the battery cover.

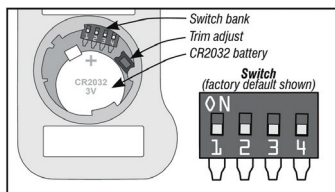

Switch 1 - Not used

Switch 2 - Resolution

To change the resolution from 0.1 °C (factory default) to 1 °C push the switch away from the batteries.

Switch 3 - Auto-off

To disable the auto-off (factory default - 10 minutes) push the switch away from the batteries.

Switch 4 - Reading Trim

For normal use, we do not recommend using the 'Trim Adjust'. For further details visit www.etiltd.com

INSTRUMENT CLEANING - Clean the instrument regularly with an anti-bacterial probe wipe to avoid potential food-borne bacteria growth.

BATTERY REPLACEMENT - A battery symbol indicates that the batteries will need replacing. The instrument continues to measure accurately but we recommend that the batteries be changed as soon as possible. To replace the batteries, remove the battery cover using a coin. Remove the batteries by pulling the battery retaining clip back whilst holding the unit upside down. Replace both batteries, positive side up, replace cover.

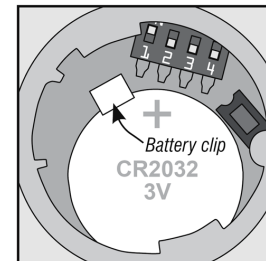

ERROR MESSAGES - 'Lo' will be displayed if you are measuring below the instrument's range. 'Hi' will be displayed if you are measuring above the instrument's range. 'Err' will be displayed if the probe develops a fault. If the error message remains, contact our service department for further assistance.

EMC/RFI - Instrument performance may be affected if operated within a high frequency radio field, such as near a mobile phone, or if subjected to an electrostatic shock.

GUARANTEE - This instrument carries a two-year guarantee against defects in either components or workmanship. During this period, products that prove to be defective will, at the discretion of ETI, be either repaired or replaced without charge. This guarantee does not apply to probes, where a six-month period is offered. The product guarantee does not cover damage caused by fair wear and tear, abnormal storage conditions, incorrect use, accidental misuse, abuse, neglect, misapplication or modification. Full details of liability are available within ETI's Terms & Conditions of Sale at www.etiltd.com/terms. In line with our policy of continuous development, we reserve the right to amend our product specification without prior notice.