

Dial Indicator, Lug Back 30mm, 0,01mm, Shockp., Coax. Rev. Count.

Item number: 3052S-19

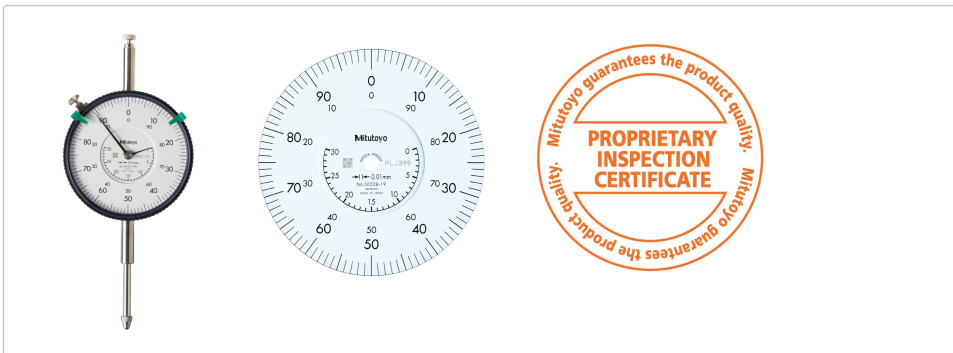

Description

This is a standard, metric dial indicator. It offers you the following benefits:

- Large-diameter dial face $\varnothing = 78 \text{ mm}$ for easy reading
- Supplied with limit markers and a bezel clamp as standard
- 0,01 / 0,001 mm graduation

Specification

Range:	30 mm
Range per rev.:	1 mm
Graduation:	0.01 mm
MPE any 1/10 revolution:	10 μm
MPE any 1/2 revolution:	11 μm
MPE any 1 revolution:	12 μm
H MPE (Hysteresis):	5 μm
Mass:	285 g
R MPE (Repeatability):	3 μm
Scale:	0-100 (0-100)
C:	25.9 mm
D:	39.4 mm
Mass lug/plain:	285/270 g
Stem:	8 mm
Contact point:	Carbide tipped, thread: M 2.5 x 0.45 mm
Delivered:	with certificate of inspection, limit indicators
Digital/Analog:	Analog
Inch-Metric:	Metric
fu:	4 μm

Dimensions

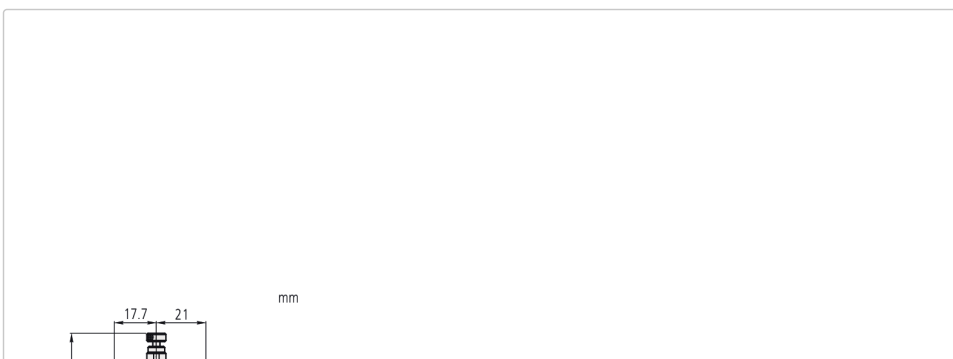

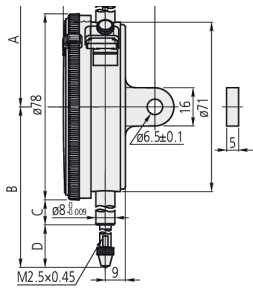

Spare parts

Consumable spares:



Contact Element Ball Point
8,3mm Length, Metric
21AZA319



Contact Element Ball Point
7,3mm Length, Carbide, Metric
901312