

## Dial Indicator, Lug Back 50mm, 0,01mm, Shockp., Coax. Rev. Count.

Item number: 3058S-19



### Description

This is a standard, metric dial indicator. It offers you the following benefits:

- Large-diameter dial face  $\varnothing = 78$  mm for easy reading
- Supplied with limit markers and a bezel clamp as standard
- 0,01 / 0,001 mm graduation

### Specification

Range:	<b>50 mm</b>
Range per rev.:	<b>1 mm</b>
Graduation:	<b>0.01 mm</b>
MPE any 1/10 revolution:	<b>10 <math>\mu</math>m</b>
MPE any 1/2 revolution:	<b>12 <math>\mu</math>m</b>
MPE any 1 revolution:	<b>13 <math>\mu</math>m</b>
H MPE (Hysteresis):	<b>6 <math>\mu</math>m</b>
Mass:	<b>298 g</b>
R MPE (Repeatability):	<b>3 <math>\mu</math>m</b>
Scale:	<b>0-100 (100-0)</b>
C:	<b>43.9 mm</b>
D:	<b>59.4 mm</b>
Mass lug/plain:	<b>298/283 g</b>
Stem:	<b>8 mm</b>
Contact point:	<b>Carbide tipped, thread: M 2.5 x 0.45 mm</b>
Delivered:	<b>with certificate of inspection, limit indicators</b>
Digital/Analog:	<b>Analog</b>
Inch-Metric:	<b>Metric</b>
fu:	<b>5 <math>\mu</math>m</b>

### Dimensions

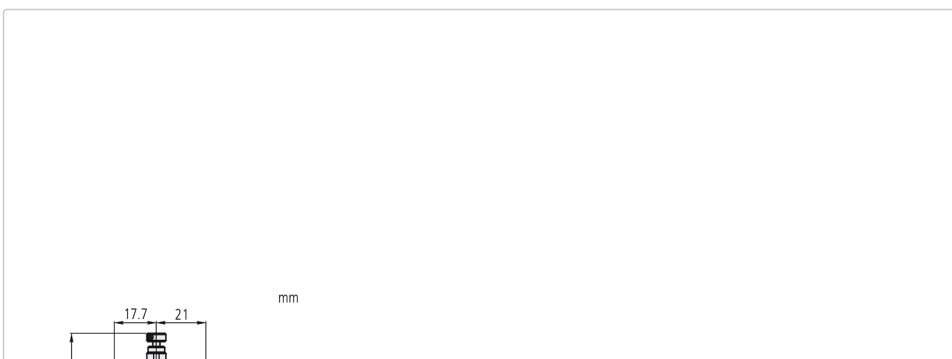

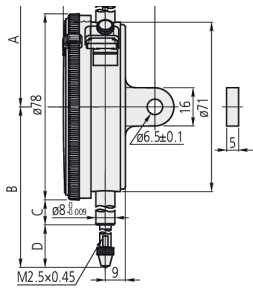

## Spare parts

### Consumable spares:



**Contact Element Ball Point**  
**8,3mm Length, Metric**  
**21AZA319**



**Contact Element Ball Point**  
**7,3mm Length, Carbide, Metric**  
**901312**