

Dial Indicator, Lug Back 100mm, 0,01mm, Shockp., Coax. Rev. Count

Item number: 3062S-19



Description

This is a standard, metric dial indicator. It offers you the following benefits:

- Large-diameter dial face $\varnothing = 78$ mm for easy reading
- Supplied with limit markers and a bezel clamp as standard
- 0,01 / 0,001 mm graduation

Specification

| | |
|--------------------------|---|
| Range: | 100 mm |
| Range per rev.: | 1 mm |
| Graduation: | 0.01 mm |
| MPE any 1/10 revolution: | 12 μm |
| MPE any 1/2 revolution: | 17 μm |
| MPE any 1 revolution: | 20 μm |
| H MPE (Hysteresis): | 9 μm |
| Mass: | 332 g |
| R MPE (Repeatability): | 3 μm |
| Scale: | 0-100 (100-0) |
| C: | 94.9 mm |
| D: | 109.4 mm |
| Mass lug/plain: | 332/317 g |
| Stem: | 8 mm |
| Contact point: | Carbide tipped, thread: M 2.5 x 0.45 mm |
| Delivered: | with certificate of inspection, limit indicators |
| Digital/Analog: | Analog |
| Inch-Metric: | Metric |
| fu: | 13 μm |

Dimensions

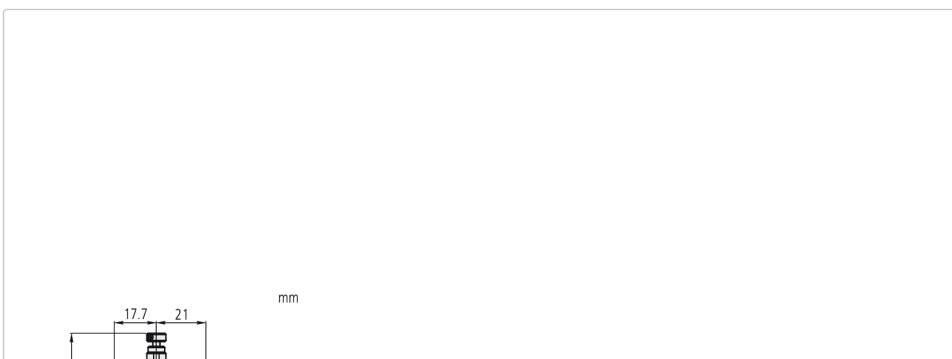

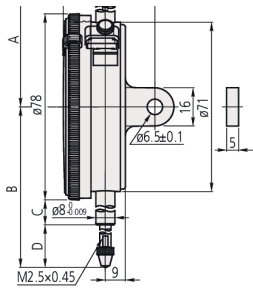

Spare parts

Consumable spares:



Contact Element Ball Point
8,3mm Length, Metric
21AZA319



Contact Element Ball Point
7,3mm Length, Carbide, Metric
901312