

Dial Indicator, Lug Back 1mm, 0,001mm, Shockproof Item number: 3109S-10



Description

This is a standard, metric dial indicator. It offers you the following benefits:

- Large-diameter dial face $\varnothing = 78 \text{ mm}$ for easy reading
- Supplied with limit markers and a bezel clamp as standard
- 0,01 / 0,001 mm graduation

Specification

Range:	1 mm
Range per rev.:	0.2 mm
Graduation:	0.01 mm
MPE any 1/10 revolution:	2.5 μm
MPE any 1/2 revolution:	4 μm
MPE any 1 revolution:	4.5 μm
H MPE (Hysteresis):	2 μm
Mass:	270 g
R MPE (Repeatability):	1 μm
Scale:	0-100-0
C:	25.9 mm
D:	14.1 mm
Mass lug/plain:	270/255 g
Stem:	8 mm
Contact point:	Carbide tipped, thread: M 2.5 x 0.45 mm
Delivered:	with certificate of inspection, limit indicators
Digital/Analog:	Analog
Inch-Metric:	Metric
fu:	2 μm

Dimensions

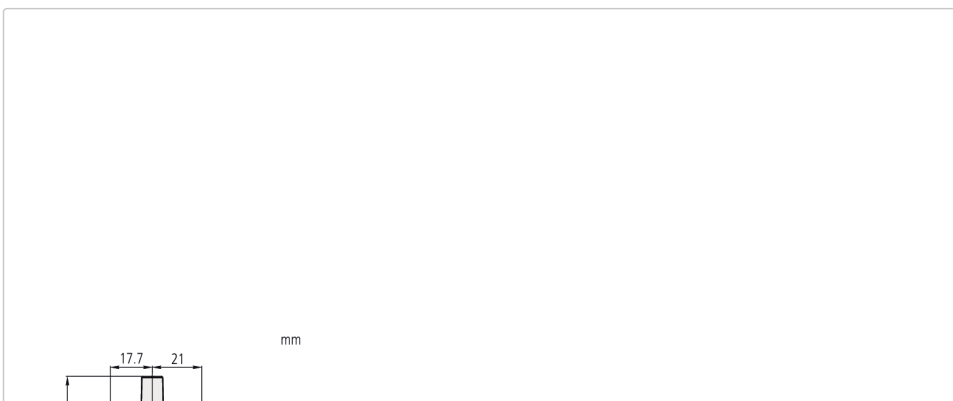

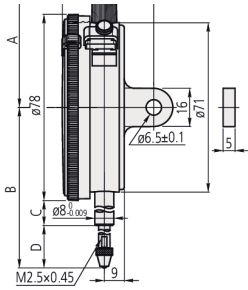

Spare parts

Consumable spares:



Contact Element Ball Point
8,3mm Length, Metric
21AZA319



Contact Element Ball Point
7,3mm Length, Carbide, Metric
901312